

QRAFT

— LIGHTING —

2021



QRAFT

— LIGHTING —

Qraft Lighting is a British based manufacturer of decorative lighting with an immense passion for designing and crafting beautiful luminaires for the hospitality and the residential market. We prioritise attention to detail, exceptional quality and fine craftsmanship.

Creative design and innovation is at the heart of our identity. Crafting decorative luminaires is an art and we have refined this art over time allowing us to transform spaces through stunning designs built to stand the test of time.

The team's roots originate from lighting, interior & product design, and manufacturing. Together we understand the process of product development and the challenges that it brings. Hence, Qraft Lighting was founded with the goal of overcoming these obstacles and to establish itself as a creative, open, honest and trustworthy lighting brand.

We craft beautiful luminaires to shape the way you light.



Collections

Crescent	04
Post	12
Oval	16
Stella	24
Wave	32
Toby	38
Buoy	44
Reading Lights	50
Technical	56

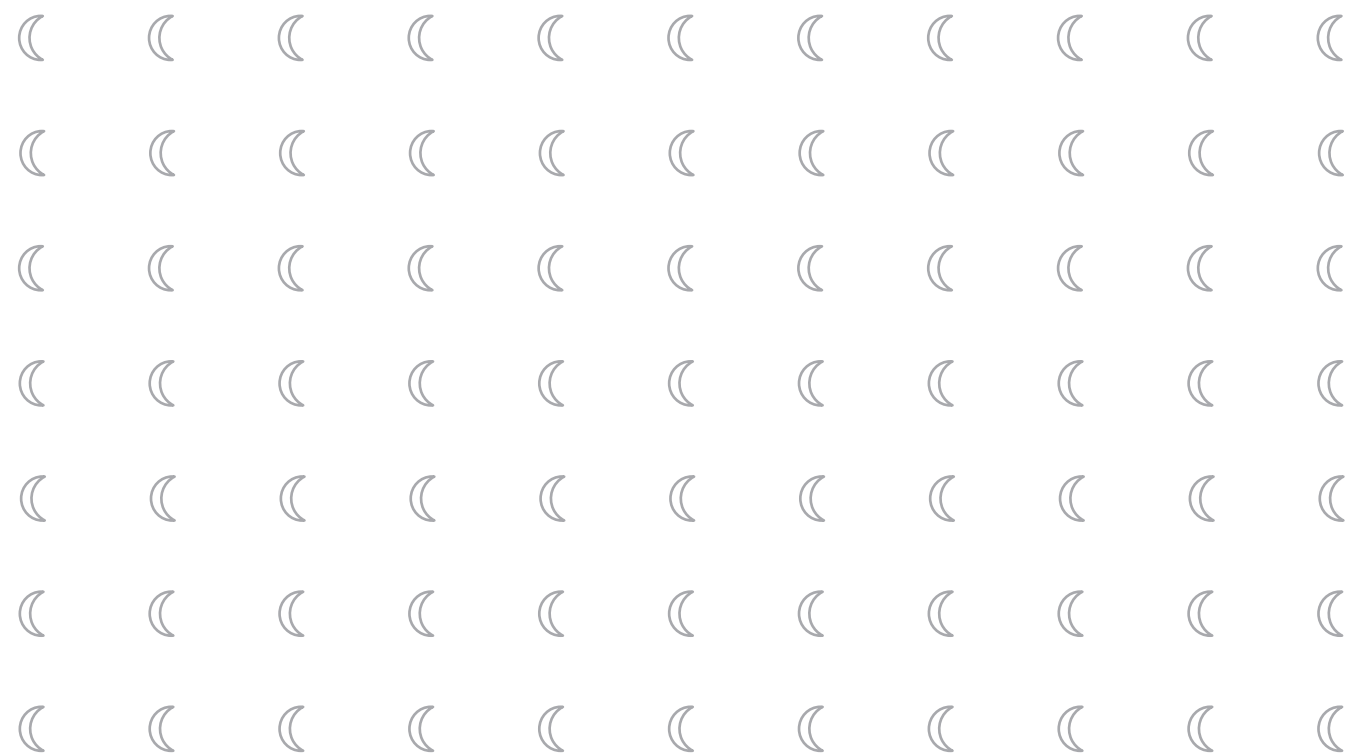

Crescent Collection

Crescent is a retro modern design inspired by the sensuous curve and form of the moon. The exquisite curved arms provide a suspension supporting the shade, which is a focal point of the design. The inner golden glow of light imitates the luminosity of the moon and adds a graceful charm to any setting. Crescent comes in either satin black and satin white finish as standard.





CRESCENT





Pendant One



Wall Lamp One



The Crescent Collection

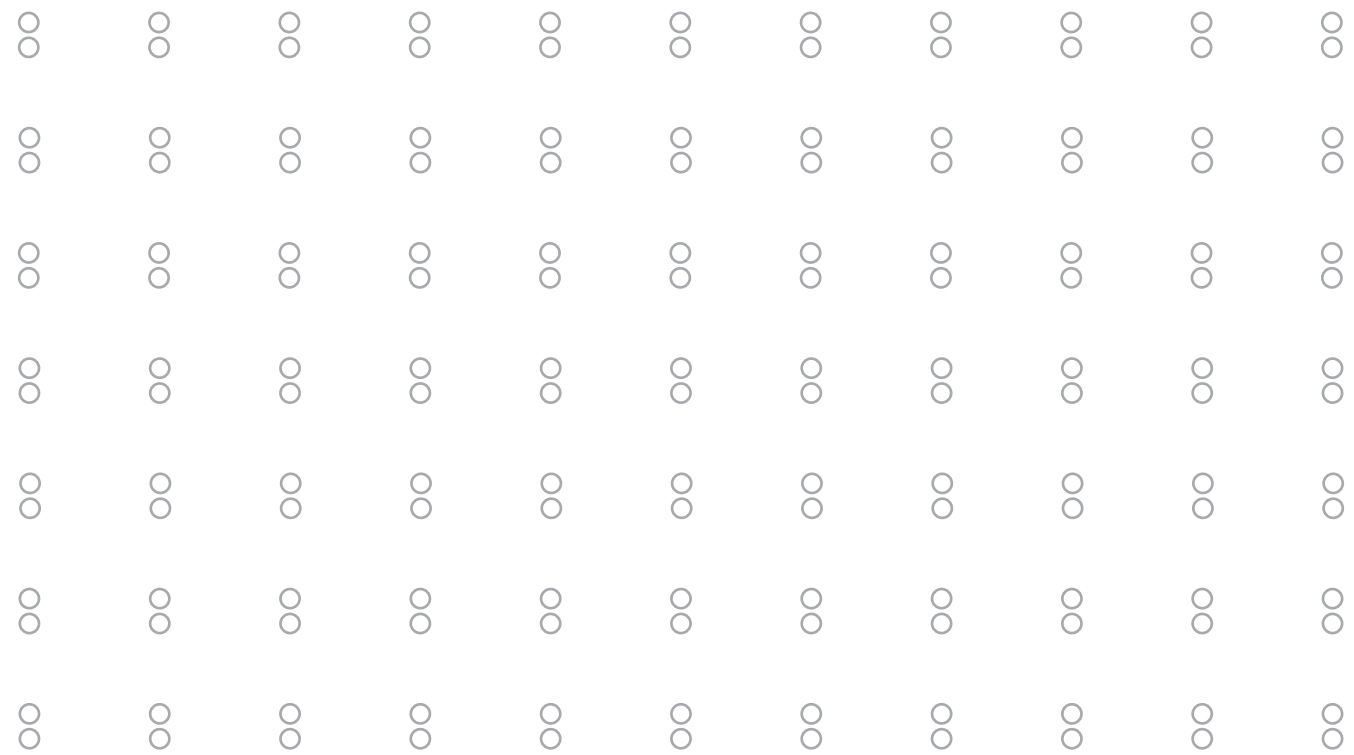

Post Collection

The all-time favourite and popular spherical design of the Post makes it an ever popular choice for any interior. A marriage of tradition and innovation, this collection is suitable for any sophisticated or industrial interior. Created in two finishes of brushed brass with opal glass or satin black with smoky tinted glass.



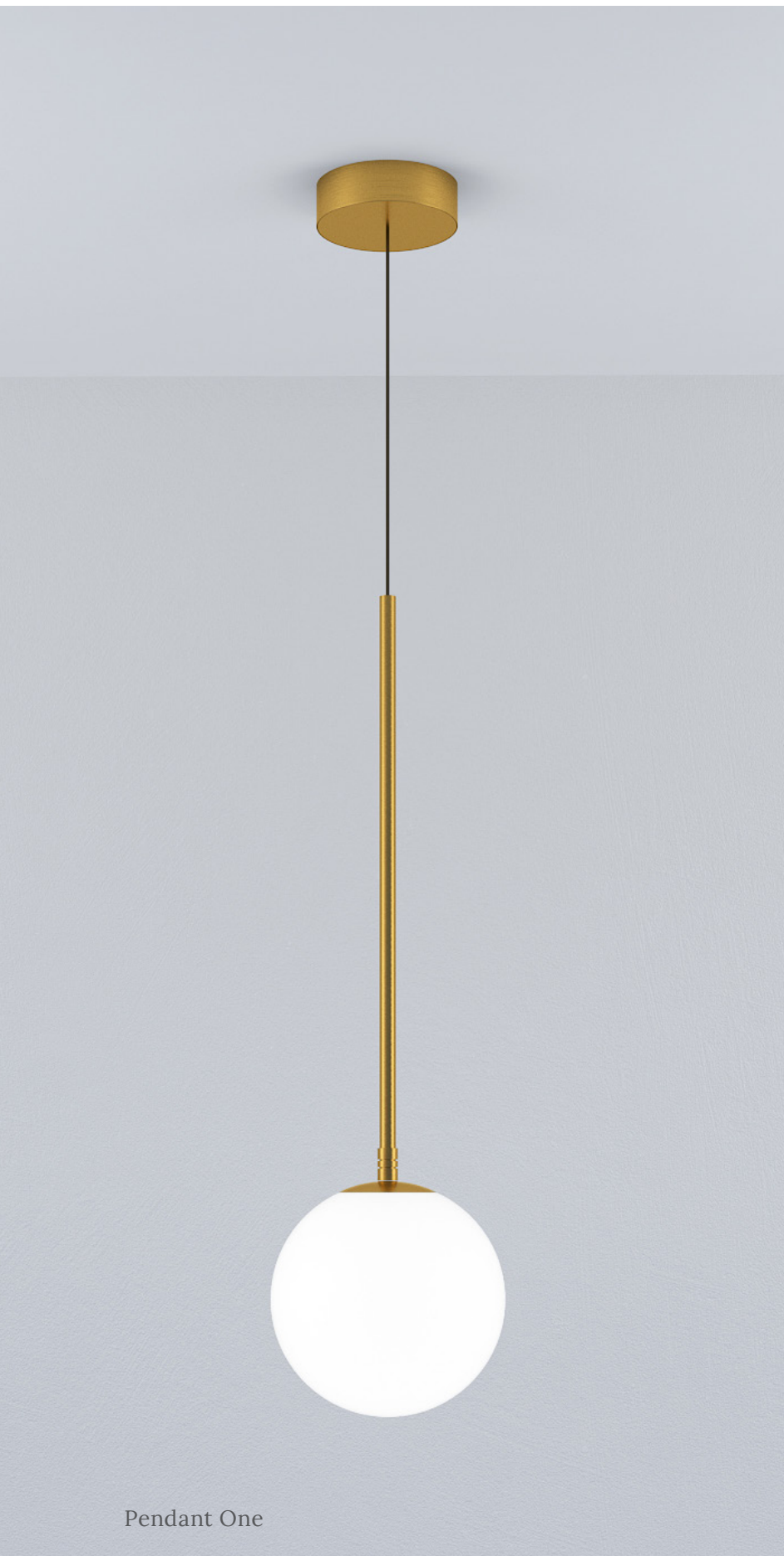

Pendant One



Pendant Four

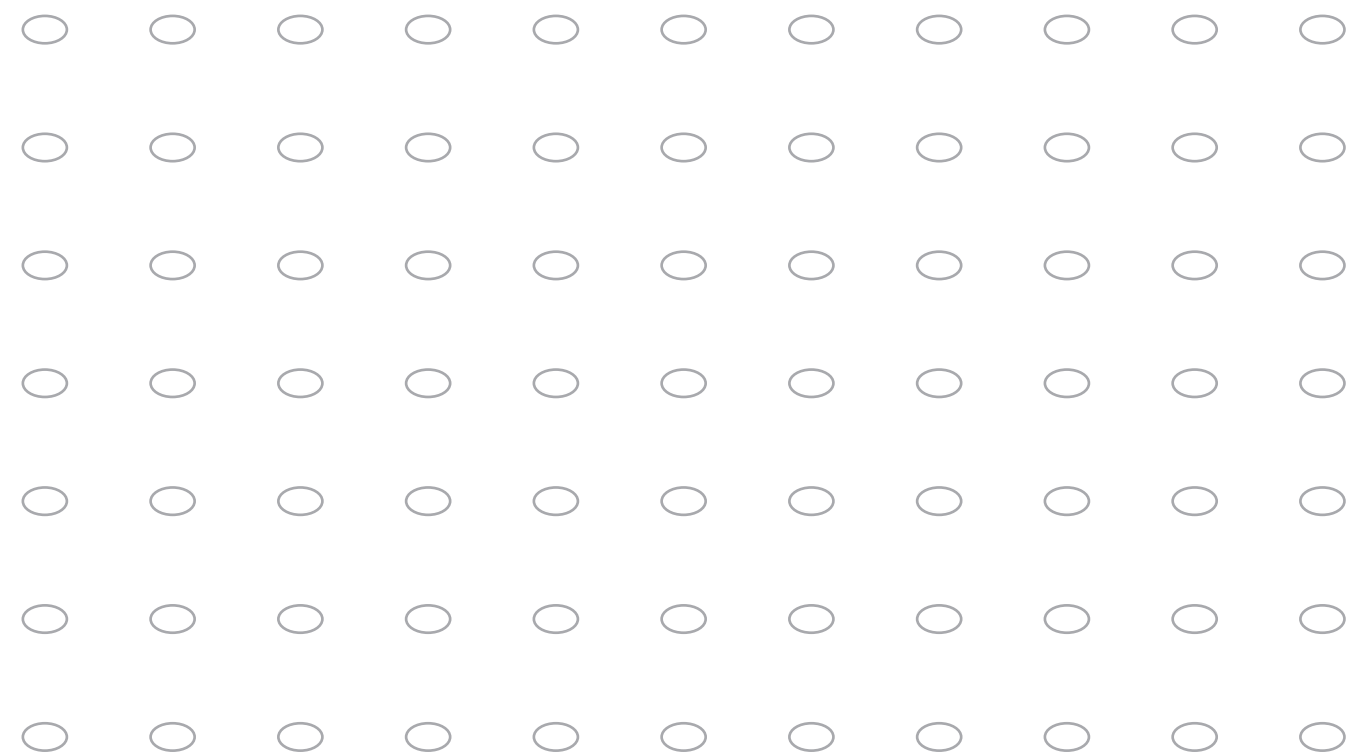

Oval Collection

A timeless and classic collection, Oval is dainty and delicate. Inspired by the elegant ovoid shape. The Oval adds an understated class to all environments that it will adorn. Available as standard in brushed brass or brushed nickel and with a choice of two different shade combinations.





OVAL



Floor Lamp



Pendant



The Oval Collection

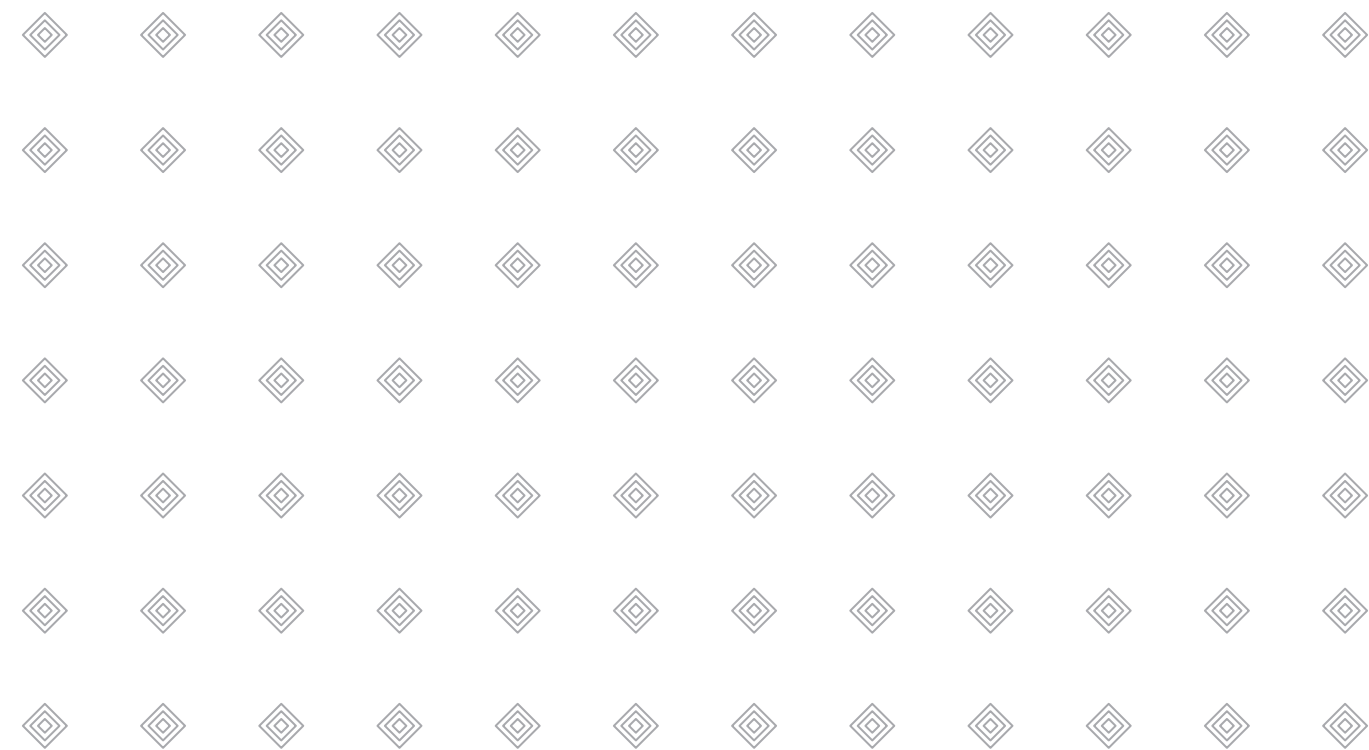

Stella Collection

Stella is an art deco inspired collection, which is versatile in any setting, yet unmistakably classy and glamorous. The cylindrical shapes combined with clear vertical glass rods and brushed brass edges encasing the light source emanating an enchanting glow. Available in both brushed brass or antique copper finishes.





STELLA



Wall Lamp Two



Table Lamp



The Stella Collection



Wave Collection

The Wave collection aims to capture the fluidity of nature's waves. Intrinsic to the design ethos of the shade's natural flow and rhythm, it is balanced delicately on a slender tubular stem. It comes in a contrasting monochromatic colour scheme and is internally lined with a flourish of gold to add a sense of drama and appeal. Also available in brushed nickel finish with an oyster cotton fabric shade.





Floor Lamp



Pendant



The Wave Collection



Toby Collection

Detailing matters. A little bit of drama, a little bit of whimsy, elevates Toby from the ordinary. A simple and minimalistic tubular design with beautiful brushed brass details and trims gives Toby a hint of luxury and makes this classic yet minimal design ideal for any interior. Available in satin black and satin white finish.



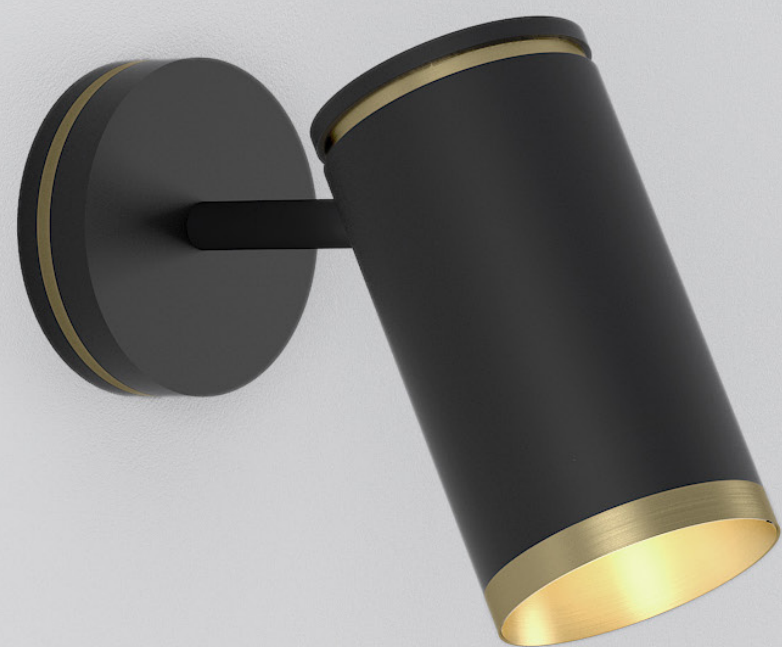

Wall Lamp One



Table Lamp



The Toby Collection



Buoy Collection

Buoy is a minimal and clean, bold yet understated battery powered table lamp. The sculptural simplicity of the silhouette directs the focus on the light source and is a showcase of innovation and creativity. The product incorporates the Qi wireless charger technology along with 'Dim To Warm' technology which enables the lamp to emit a cool and warm colour appearance depending on the level it is dimmed.



BUOY





The Buoy Collection

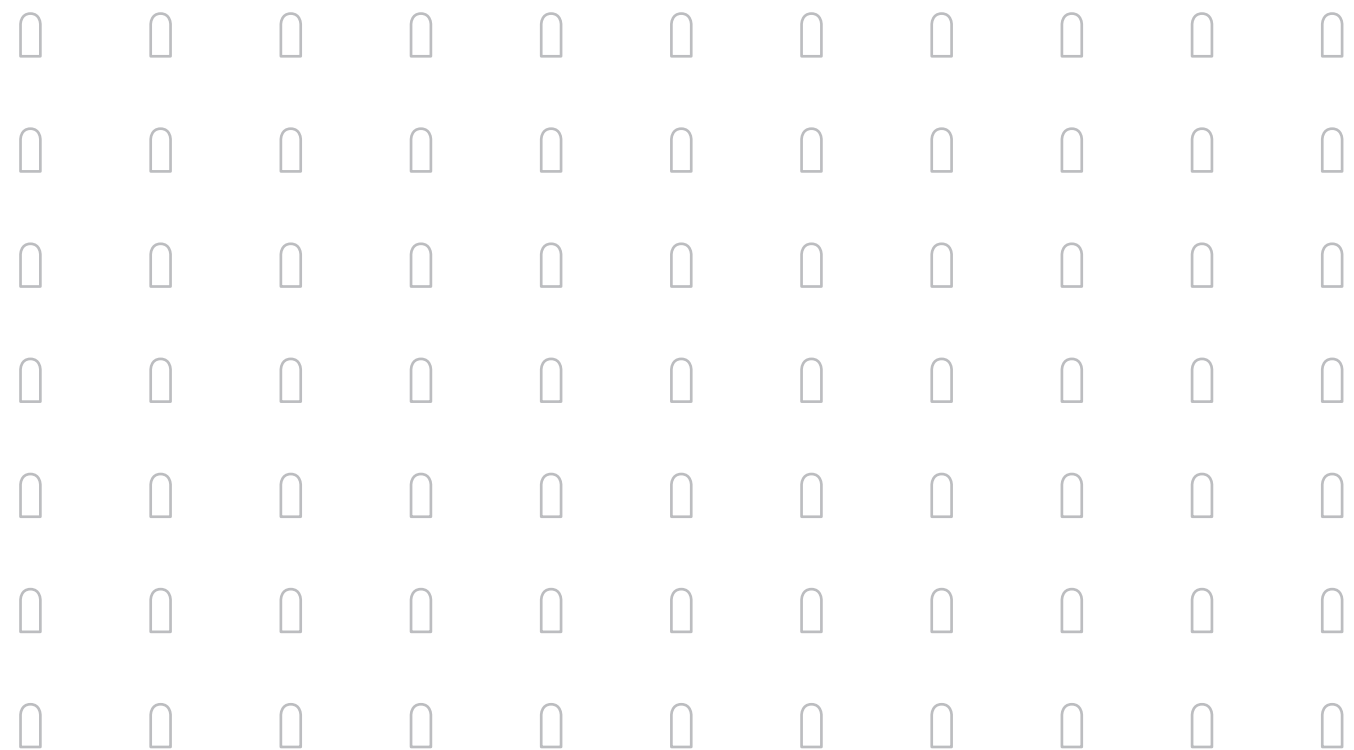

Flex & Capsule Collection

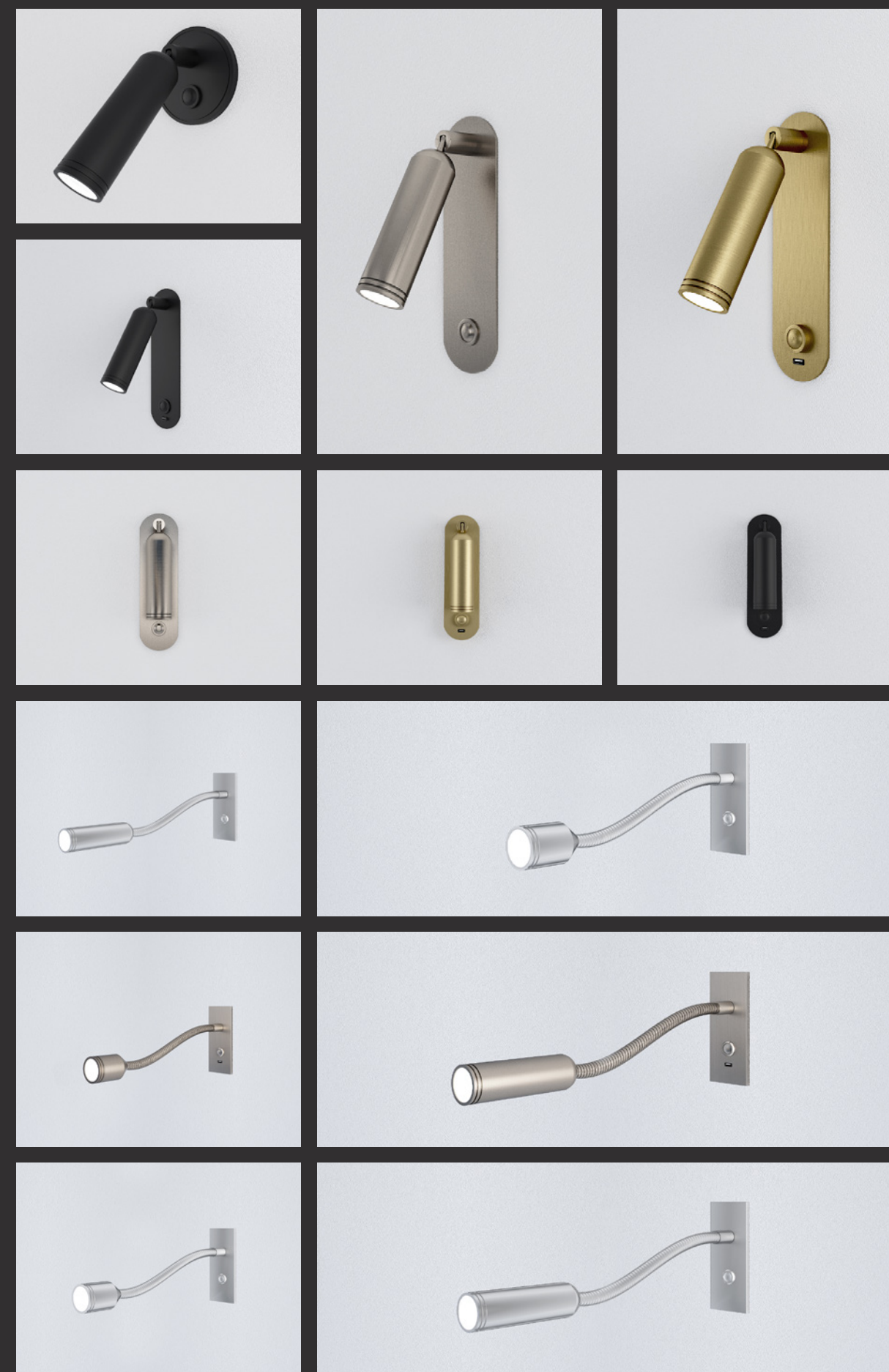

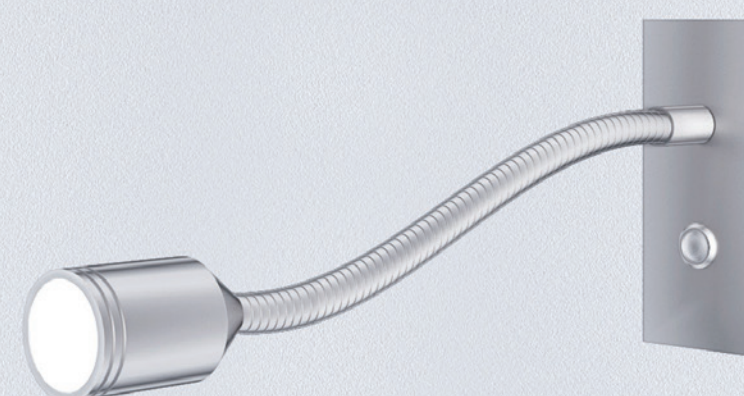
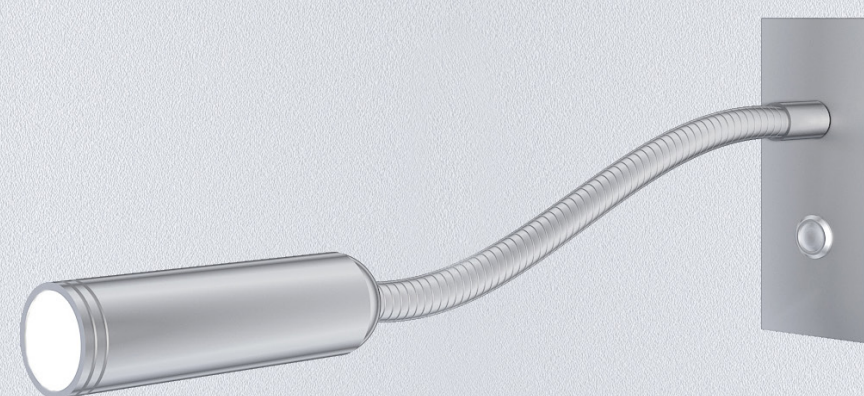
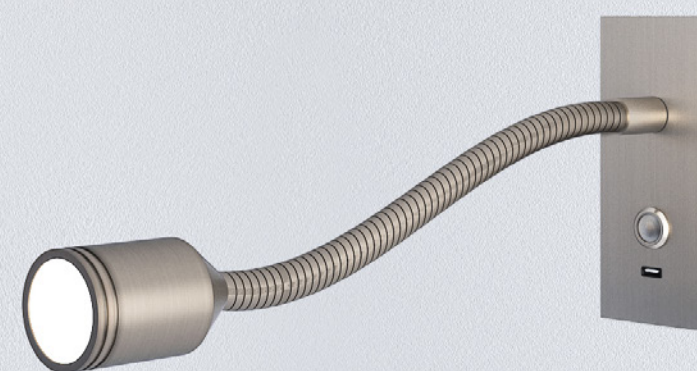
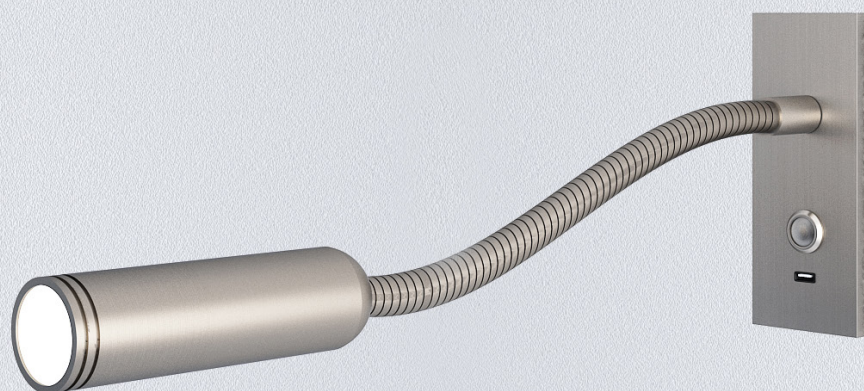

Reading Flex Collection



Reading Capsule Collection



Technical

Wall Lamps	58
Table Lamps	60
Pendants	62
Floor Lamps	66
Reading Lamps	68

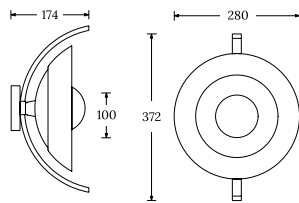

Crescent Wall Lamp One Page 04

- Lamp: 1 x E14 4W LED 2700K
- Base Weight: 3.7 kg approx.
- Satin Black
CR.WL1.SBL/BBR
- Satin White
CR.WL1.SWH/BBR

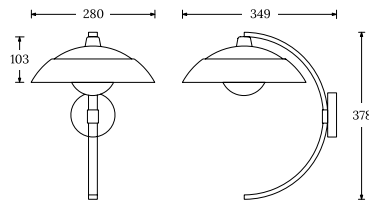

Crescent Wall Lamp Two Page 05

- Lamp: 1 x E14 4W LED 2700K
- Base Weight: 3.7 kg approx.
- Satin Black
CR.WL2.SBL/BBR
- Satin White
CR.WL2.SWH/BBR

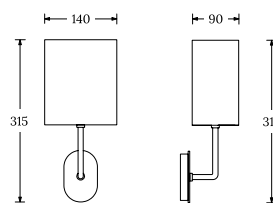

Oval Wall Lamp Page 16

- Lamp: 1 x E14 4W LED 2700K
- Base Weight: 1.2 kg approx.
- Brushed Brass
OV.W.BBR.OYC
- Brushed Nickel
OV.W.BNI.OYC

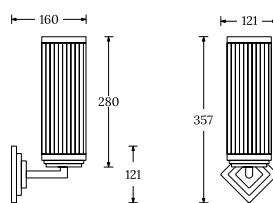

Stella Wall Lamp One Page 24

- Lamp: 1 x 6W LED integral 2700K
- Base Weight: 3.2 kg approx.
- Brushed Brass
ST.WL1.BBR
- Brushed Antique Copper
ST.WL1.BCO



Stella Wall Lamp Two Page 25

- Lamp: 2 x 4W LED integral 2700K
- Base Weight: 3 kg approx.
- Brushed Brass
ST.WL2.BBR
- Brushed Antique Copper
ST.WL2.BCO



Toby Wall Lamp One Page 38

- Lamp: 1 x GU10 4W LED 2700K
- Base Weight: 1 kg approx.
- Satin Black
TO.WL1.SBL/BBR
- Satin White
TO.WL1.SWH/BBR



Toby Wall Lamp Two Page 39

- Lamp: 1 x GU10 4W LED 2700K
- Base Weight: 1.5 kg approx.
- Satin Black
TO.WL2.SBL/BBR
- Satin White
TO.WL2.SWH/BBR

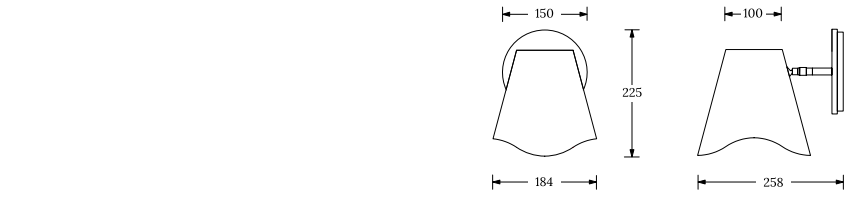

Wave Wall Lamp Page 32

- Lamp: 1 x E14 4W LED 2700K
- Base Weight: 1.4 kg approx.
- Satin Black / Silken Black
WA.W.SBL.SIB
- Brushed Nickel / Oyster Cotton
WA.W.BNI.OYC

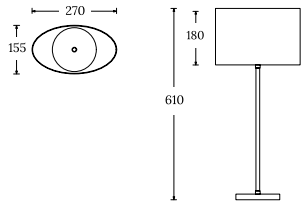

Oval Table Lamp Page 16

- Lamp: 1 x E27 8W LED 2700K
- Base Weight: 4 kg approx.
- Brushed Brass
OV.TL.BBR.OYC
- Brushed Nickel
OV.TL.BNI.OYC

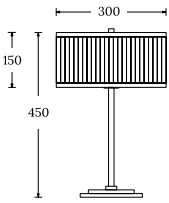

Stella Table Lamp Page 24

- Lamp: 1 x 5W LED integral 2700K
- Base Weight: 6.5 kg approx.
- Brushed Brass
ST.TL.BBR
- Brushed Antique Copper
ST.TL.BCO

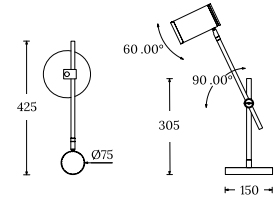

Toby Table Lamp Page 38

- Lamp: 1 x GU10 4W LED 2700K
- Base Weight: 4.5 kg approx.
- Satin Black
TO.TL.SBL/BBR
- Satin White
TO.TL.SWH/BBR

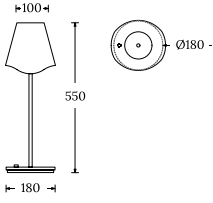

Wave Table Lamp One Page 32

- Lamp: 1 x E14 4W LED 2700K
- Base Weight: 3.7 kg approx.
- Satin Black / Silken Black
WA.TL1.SBL.SIB
- Brushed Nickel / Oyster Cotton
WA.TL1.BNI.OYC

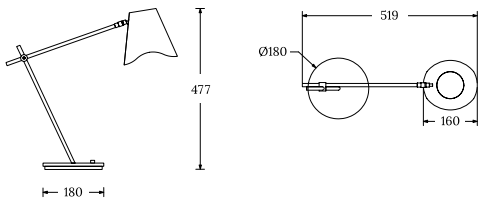

Wave Table Lamp Two Page 33

- Lamp: 1 x E14 4W LED 2700K
- Base Weight: 3.7 kg approx.
- Satin Black / Silken Black
WA.TL2.SBL.SIB
- Brushed Nickel / Oyster Cotton
WA.TL2.BNI.OYC

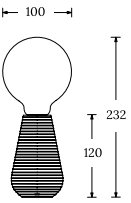

Bouy Battery Powered Lamps Page 44

- Lamp: 1.8W Special Retrofit 1800K-2500K
- Base Weight: 0.5 kg approx.
- Black
BU.TLB.CONB
- White
BU.TLB.CONW
- Grey
BU.TLB. CONG

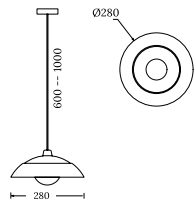

Crescent Pendant One Page 04

Lamp: 1 x E14 4W LED 2700K Base Weight: 1.6 kg approx.

Satin Black
CR.P1.SBL/BBR
 Satin White
CR.P1.SWH/BBR

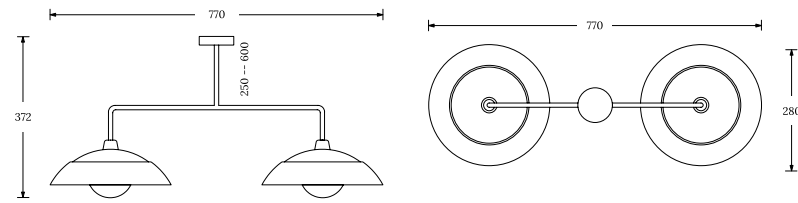

Crescent Pendant Two Page 05

Lamp: 1 x E14 4W LED 2700K Base Weight: 3.2 kg approx.

Satin Black
CR.P2.SBL/BBR
 Satin White
CR.P2.SWH/BBR

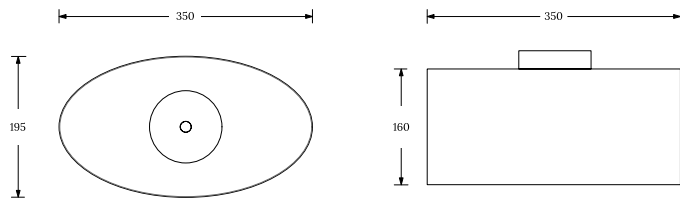

Oval Ceiling Page 16

Lamp: 1 x E27 8W LED 2700K Base Weight: 2 kg approx.

Brushed Brass
OV.CE.BBR.OYC
 Brushed Nickel
OV.CE.BNI.OYC

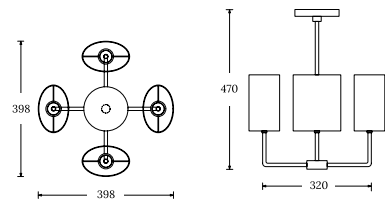

Oval Pendant Page 17

Lamp: 1 x E14 4W LED 2700K Base Weight: 5.2 kg approx.

Brushed Brass
OV.CH.BBR.OYC
 Brushed Nickel
OV.CH.BNI.OYC



Post Pendant One Page 12

Lamp: 1 x E14 4W LED 2700K Base Weight: 1.6 kg approx.

Brushed Brass / Opal Glass
PO.P1.BBR/OP
 Satin Black / Tinted Glass
PO.P1.SBL/TGL

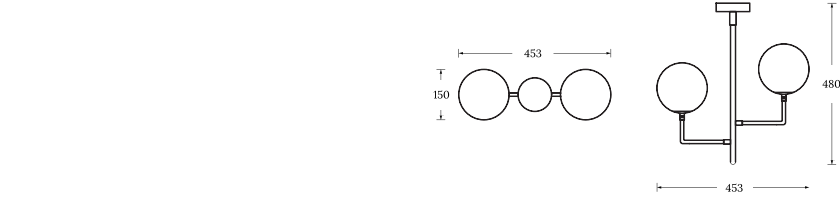

Post Pendant Two Page 13

Lamp: 2 x E14 4W LED 2700K Base Weight: 2.4 kg approx.

Brushed Brass / Opal Glass
PO.P2.BBR/OP
 Satin Black / Tinted Glass
PO.P2.SBL/TGL

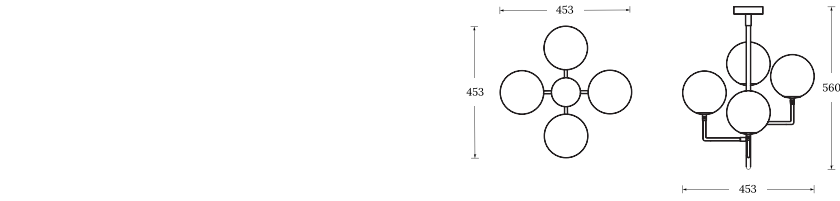

Post Pendant Three Page 14

Lamp: 4 x E14 4W LED 2700K Base Weight: 3.5 kg approx.

Brushed Brass / Opal Glass
PO.P3.BBR/OP
 Satin Black / Tinted Glass
PO.P3.SBL/TGL



Stella Ceiling Page 24

Lamp: 1 x 15W LED integral 2700K Base Weight: 10 kg approx.

Brushed Brass
ST.CE.BBR
 Brushed Antique Copper
ST.CE.BCO



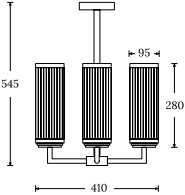

Stella Pendant Page 25

Lamp: 4 x 6W LED integral 2700K	Base Weight: 14 kg approx.
 Brushed Brass ST.CH.BBR	 Brushed Antique Copper ST.CH.BCO

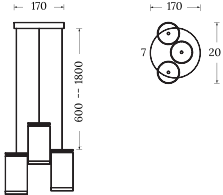

Toby Pendant Page 38

Lamp: 3 x GU10 4W LED 2700K	Base Weight: 5.8 kg approx.
 Satin Black TO.P.SBL/BBR	 Satin White TO.P.SWH/BBR

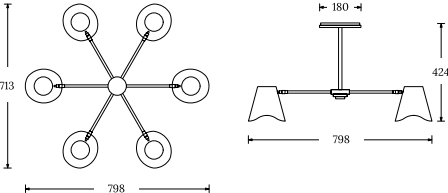

Wave Pendant Page 35

Lamp: 6 x E14 4W LED 2700K	Base Weight: 9 kg approx.
 Satin Black / Silken Black WA.CH.SBL.SIB	 Brushed Nickel / Oyster Cotton WA.CH.BNI.OYC

blank page

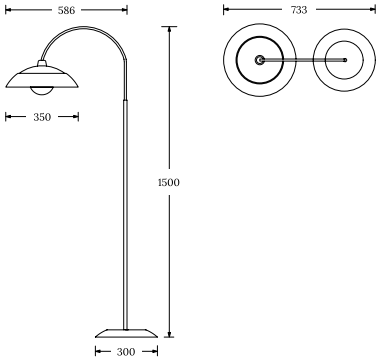

Crescent Floor Lamp Two Page 10

Lamp: 1 x E14 4W LED 2700K Base Weight: 13 kg approx.

● Satin Black ● Satin White
CR.FL2.SBL/BBR CR.FL2.SWH/BBR

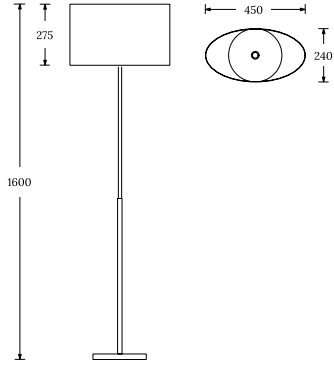

Oval Floor Lamp Page 20

Lamp: 1 x E27 8W LED 2700K Base Weight: 8.5 kg approx.

● Brushed Brass ● Brushed Nickel
OV.FL.BBR.OYC OV.FL.BNI.OYC

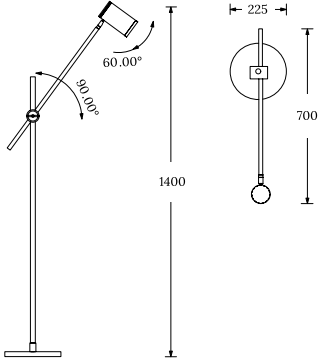

Toby Floor Lamp Page 42

Lamp: 1 x GU10 4W LED 2700K Base Weight: 9.5 kg approx.

● Satin Black ● Satin White
TO.FL.SBL/BBR TO.FL.SWH/BBR

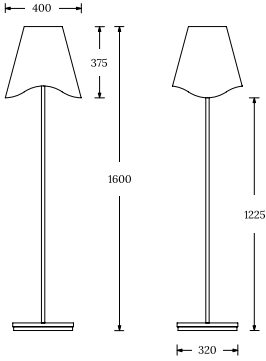

Page 36 Wave Floor Lamp

Lamp: 1 x E27 8W LED 2700K Base Weight: 8.5 kg approx.

● Satin Black / Silken Black ● Brushed Nickel / Oyster Cotton
WA.FL.SBL.SIB WA.FL.BNI.OYC



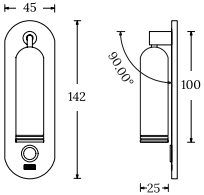

Capsule Reading Lamp One Page 54

Lamp: 1 x 1W LED integral 2700K with USB port Base Weight: 0.3 kg approx.

● Brushed Brass CA.RL1.BBR ● Brushed Nickel CA.RL1.BNI ● Satin Black CA.RL1.SBL

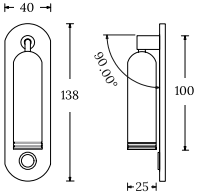

Capsule Reading Lamp Two Page 54

Lamp: 1 x 1W LED integral 2700K Base Weight: 0.3 kg approx.

● Brushed Brass CA.RL2.BBR ● Brushed Nickel CA.RL2.BNI ● Satin Black CA.RL2.SBL

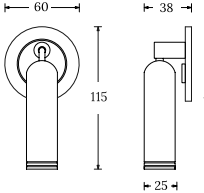

Capsule Reading Lamp Three Page 51

Lamp: 1 x 1W LED integral 2700K Base Weight: 0.3 kg approx.

● Brushed Brass CA.RL3.BBR ● Brushed Nickel CA.RL3.BNI ● Satin Black CA.RL3.SBL

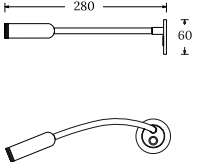

Flex Reading Lamp One Page 51

Lamp: 1 x 1W LED integral 2700K Base Weight: 0.5 kg approx.

● Brushed Nickel FLE.RL1.BNI/BNI ● Polished Chrome FLE.RL1.PCH/PCH



Page 52 Flex Reading Light Two

Lamp: 1 x 1W LED integral 2700K with USB port Base Weight: 0.5 kg approx.

● Brushed Nickel FLE.RL2.BNI/BNI ● Polished Chrome FLE.RL2.PCH/PCH



Page 52 Flex Reading Lamp Three

Lamp: 1 x 1W LED integral 2700K Base Weight: 0.5 kg approx.

● Brushed Nickel FLE.RL3.BNI/BNI ● Polished Chrome FLE.RL3.PCH/PCH



Page 51 Flex Reading Lamp Four

Lamp: 1 x 1W LED integral 2700K Base Weight: 0.5 kg approx.

● Brushed Nickel FLE.RL4.BNI/BNI ● Polished Chrome FLE.RL4.PCH/PCH



Page 53 Flex Reading Lamp Five

Lamp: 1 x 1W LED integral 2700K with USB port Base Weight: 0.5 kg approx.

● Brushed Nickel FLE.RL5.BNI/BNI ● Polished Chrome FLE.RL5.PCH/PCH



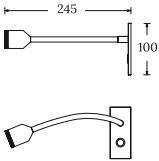

Flex Reading Lamp Six

Page 53

Lamp: 1 x 1W LED integral 2700K

Base Weight: 0.5 kg approx.

● Brushed Nickel
FLE.RL6.BNI/BNI

● Polished Chrome
FLE.RL6.PCH/PCH

blank page

Bespoke

Do not see the design you want? Then why not create and design your own. Working alongside private clients, architect, and interior designers alike we can help customise any design. Whether it is to change a colour or to alter the size, we have fine tuned our manufacturing capability to cater for all needs. Our flexibility and ability to adapt sets us apart from our competition.



